

Thermowells Weld-In

Available in style 260 for 1/4" diameter sensors and style 385 for 3/8" sensors.

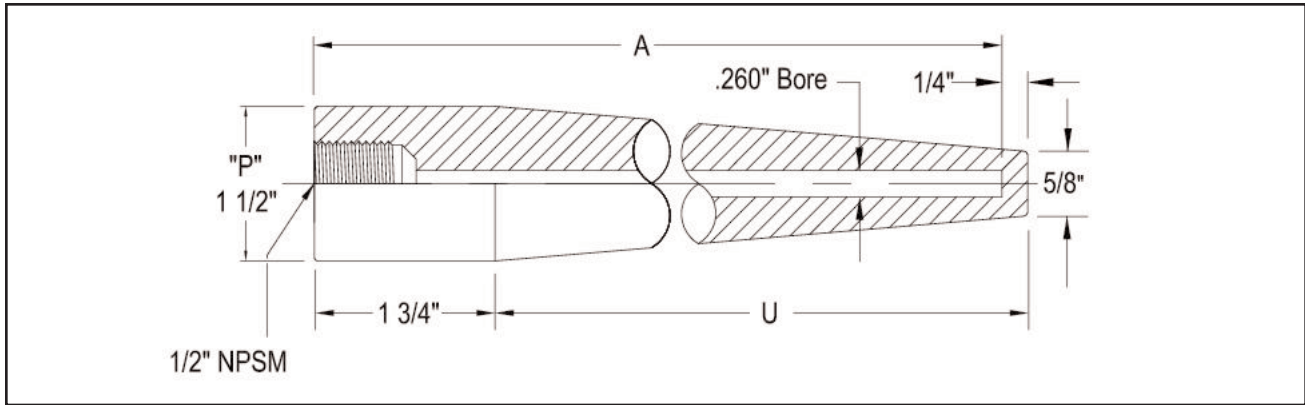

Weld-in with .260" Bore

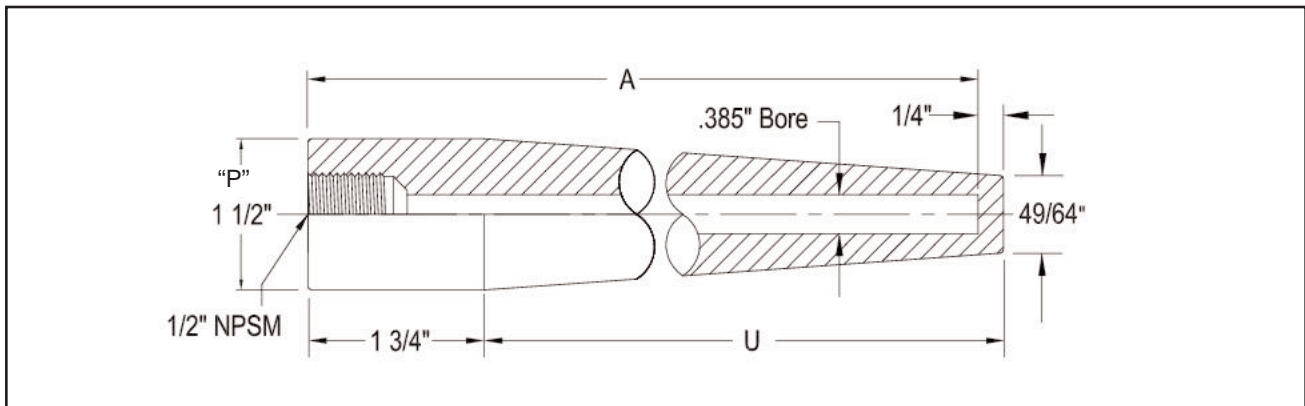

Weld-in with .385" Bore

Connection	Socket		
1.5	1.5"		
	Model	Bore and Thermowell Type	
	Weld-in 260	.260" Bore	
	Weld-in 385	.385" Bore	
	Insertion Length	Stem Length "A"	Insertion Length "U"
	U2 1/2	4"	2 1/2"
	U4 1/2	6"	4 1/2"
	U7 1/2	9"	7 1/2"
	U10 1/2	12"	10 1/2"
	U13 1/2	15"	13 1/2"
	U16 1/2	18"	16 1/2"
	U22 1/2	24"	22 1/2"
	Material	Thermowell Material	
	316SS	AISI-316 Stainless Steel - Standard	
	304SS	AISI-304 Stainless Steel	
	Brass	Brass	
	CS	Carbon Steel	
	Monel	Monel 400	
	Other	Consult Factory	

1.5 - Weld-in 260 - U21/2 - 316SS	Sample Model Number
- - -	Your Part Number

Specifications:

Process Connection "P":	1 1/2" diameter pipe size.
Thermowell Style:	Specify style and bore.
Insertion Length "U":	From bottom of socket to tip of thermowell . Standard sizes listed - other sizes available.
Materials:	Standard materials listed - others available. Refer to the Corrosive Service Guide to Materials in the Thermowell General Specifications determine suitable material for specific application.
Instrument Connection Size:	1/2" NPSM female internal thread is standard (1/2" or 3/4" NPT available).
Cap & Chain:	Brass cap and chain is available for keeping well bore clean when not in use. Add "C&C" to the end of your model number to order this option.